



Oviedo High School Curriculum Night

Dr. Trent Daniel
and

Matthew Guglielmello



How will your next four years be?

Presentation designed based on Oviedo Community Feedback

- Freshmen Meeting (AP Human Geo)
- Curriculum Showcase (Commons) 6-8
- Athletics Meeting (7 pm Auditorium)
- AP Curriculum Walkthrough (Building 8)
- SCPS Choices, Seminole State College, and Seminole Virtual School

OHS Curriculum Guide

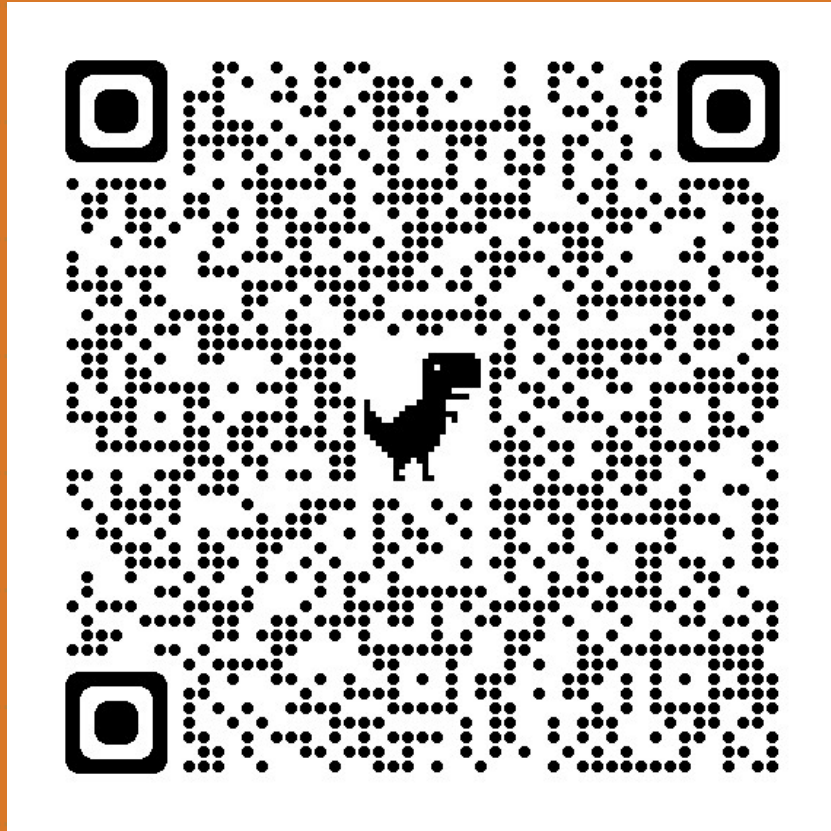

Student Progression Plan





SCIENCE



ENGLISH

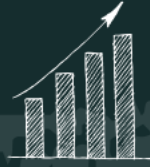

MATH



**SOCIAL
SCIENCE**



**WORLD
LANGUAGE**



ART



BIOTECH

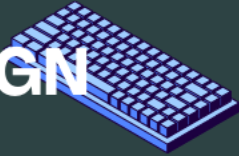

WEB DESIGN



TV PRODUCTION



CULINARY



AUTO REPAIR



DIGITAL DESIGN

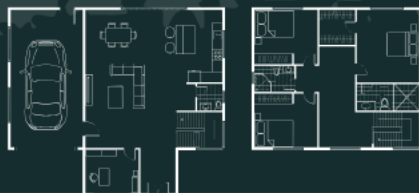

INTERIOR DESIGN



EARLY CHILDHOOD ED



PHYS. ED



BAND



DANCE



NEUROTC

**WELCOME FUTURE
LIONS!**



CHORUS



Dr. Trent Daniel
Principal



Tanya Cameron
Assistant Principal



Nancy Diaz
Assistant Principal



Jaclyn DiMatteo
Assistant Principal



Matt Guglielmello
Assistant Principal

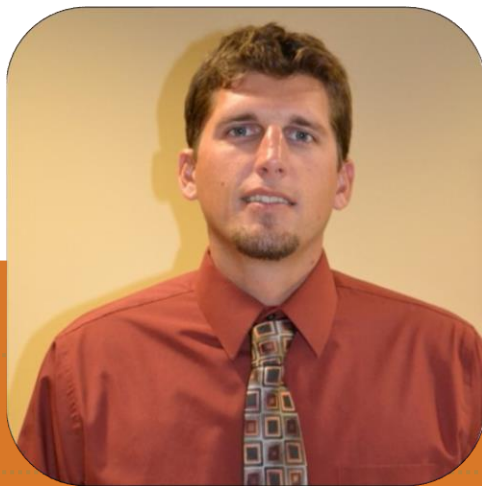

Drew Morgan
Assistant Principal



Demetrius Galindez
School Admin Manager



John Rondone
School Admin Manager

Oviedo High School Counselors



Graduation Requirements (26 Credits)

- 4 credits of English (English 1, 2, 3, 4)
- 4 credits of Math (Must be earned 9-12 gr. Including: Alg 1, Geom)
- 4 credits of Science (with a lab component, must have Biology)
- 3 credits of Social Studies (World History, US History, Govt/Econ)
- 1 credit of PE (Substitutions on Page 42 of SPP - 0.5 credit must be Personal Fitness)
- 1 Fine Arts or Practical Arts credit
- 0.5 credits of Personal Financial Literacy w/ Money Management (c/o 2027 & 2028)
- 8.5 additional elective credits

** College bound students should take 2 years of the same world language.

Four Year Plan

| Classes | Freshmen | Sophomore | Junior | Senior |
|----------------|---|------------------|---------------------|-----------------|
| English | English 1 | English 2 | English 3 | English 4 |
| Math | Algebra 1 | Geometry | Algebra 2 | Prob/Statistics |
| Science | Biology | Physical Science | Earth Space Science | Ecology |
| Social Science | | World History | US History | Gov/Econ |
| Elective | Personal Fitness/ Financial Literacy | Team Sports 1/2 | | |
| Elective | Spanish 1 | Spanish 2 | | |
| Elective | Art 2-D/Art 3-D | | | |

Four Year Plan (Sample)

| Classes | Freshmen | Sophomore | Junior | Senior |
|----------------|---|------------------|---------------------|------------------|
| English | English 1 Hon | English 2 Hon | AP Language | AP Literature |
| Math | Geometry | Algebra 2 | Statistics Honors | AP Statistics |
| Science | Biology | Physical Science | Earth Space Science | Anatomy |
| Social Science | AP Human Geo | AP World History | AP US History | Gov/Econ Hon |
| Elective | Band 1 | Band 2 | Band 3 (Hon) | Band 4 (Hon) |
| Elective | French 1 | French 2 | French 3 | AP French |
| Elective | Personal Fitness/ Financial Literacy | Creative Photo 1 | Creative Photo 2 | Creative Photo 3 |

Four Year Plan (Sample)

| Classes | Freshmen | Sophomore | Junior | Senior |
|----------------|---|-------------------|-----------------|-----------------|
| English | English 1 | English 2 | English 3 | English 4 |
| Math | Algebra 2 Hon | AP Precalc | AP Calc AB | AP Calc BC |
| Science | Biology | Chem Hon | AP Physics | AP Physics C |
| Social Science | Personal Fitness/ Financial Literacy | World History Hon | US History Hon | Gov/Econ Hon |
| Elective | Naval Science 1 | Naval Science 2 | Naval Science 3 | Naval Science 4 |
| Elective | Biotech 1 | Biotech 2 | Biotech 3 | Biotech 4 |
| Elective | Spanish 1 | Spanish 2 | Spanish 3 | AP Spanish Lang |

Other Graduation Requirements

- 2.0 Grade Point Average on a 4.0 scale
- Pass the 10th Grade FSA/FAST ELA with a level 3 or higher
- Pass the Algebra or Geometry EOC with a level 3 or higher
- Participate in all EOCs
(Algebra/Geometry/Biology/US History)
 - EOCs also count for 30% of Final Grades

GPA Terminology

| | Honors | AP/Dual Enrollment |
|----------------------|--------------------|--------------------|
| Unweighted GPA Scale | Weighted GPA Scale | Weighted GPA Scale |
| A = 4 Points | A = 4.5 Points | A = 5 Points |
| B = 3 Points | B = 3.5 Points | B = 4 Points |
| C = 2 Points | C = 2.5 Points | C = 3 Points |
| D = 1 Point | D = 1 Point | D = 1 Point |
| F = 0 Points | F = 0 Points | F = 0 Points |

- AP credits are 1 year.
- Dual Enrollment are $\frac{1}{2}$ a year.

What to Watch For

- Pre-Requisites!
 - Studio Art 2-D and Studio Art 3-D requires 2-D Art and 3-D Art
 - Math and Science courses have several pre/co-Requisites
- Double check if courses are Semester (0.5 Credits) or Year-Long (1.0 Credits)
- Make sure you don't already have credit in the course
- Course Request Deadline is **February 9th, 2024**
- 8th Grade Course Requests

FAQs Middle School Courses

- Details on the SPP pages 36-37
- High School credit math courses count as elective credits
- Students who earn a “C”, “D”, or “F” can retake the same or comparable course and replace the grade with a “C” or higher earned in the replacement course.
- Course history will remain on the transcript, but the GPA calculation will only use the replacement grade.

FAQs and Help Desk at Building 8

- Transfer Options and Questions - SCPS Choices Department Table
- SCVS and Flex options – Seminole County Virtual School Representative
- Bright Futures Questions – OHS Guidance Table
- Dual Enrollment Questions – Seminole State Table

FAQs

- Athletic Clearance and Sports related questions will be answered at the 7:00 presentation in the Auditorium
- PE classes will require dressing out for a grade
- Principal's Update is sent weekly via School Messenger and posted on our OHS Website.
- **Student E-mails** are primary means of communication
- Student Schedules will be visible on August 1st.
- During Freshmen Orientation we allow students to visit the campus and practice their walking their schedule. This date is set by the district and the same for all high schools.
- 1st Day of school is Monday, August 12th.

Standardized Testing Schedules

| YEAR | TEST | PURPOSE |
|-----------|---|--|
| Freshmen | Fall PSAT | 430 or higher in math qualifies for grad requirement AP Potential |
| Sophomore | Fall PSAT | 430 or higher in math qualifies for grad requirement AP Potential |
| Junior | Fall PSAT Fall ACT Spring ACT Spring SAT | National Merit for PSAT College Admissions for SAT/ACT College Admissions Graduation Concordant |
| Senior | Fall SAT | College Admissions for SAT/ACT College Admissions Graduation Concordant |

Questions?

AP Student Panel

Spencer Mallot
and
Audrey Keke